

Franke Hestia J Spout Tap

Replacing Cartridge and O-Rings

Replacing the cartridge

Before replacing the cartridge, you will need to turn the water off. You will need to remove the handle retaining screw (1) by using a 2.5mm allen key. Once you've pulled the handle off (2), you can unscrew the brass screw (3) holding the white plastic handle insert (4) in place. You will then be able to remove the existing valve (5) and replace with the new parts.

Replacing the o rings

To replace the o rings, you will need to remove the spout retaining screw (6) by using a 2.5mm allen key. Once the spout (7) is removed, you can replace the o rings (8) with the replacement parts.

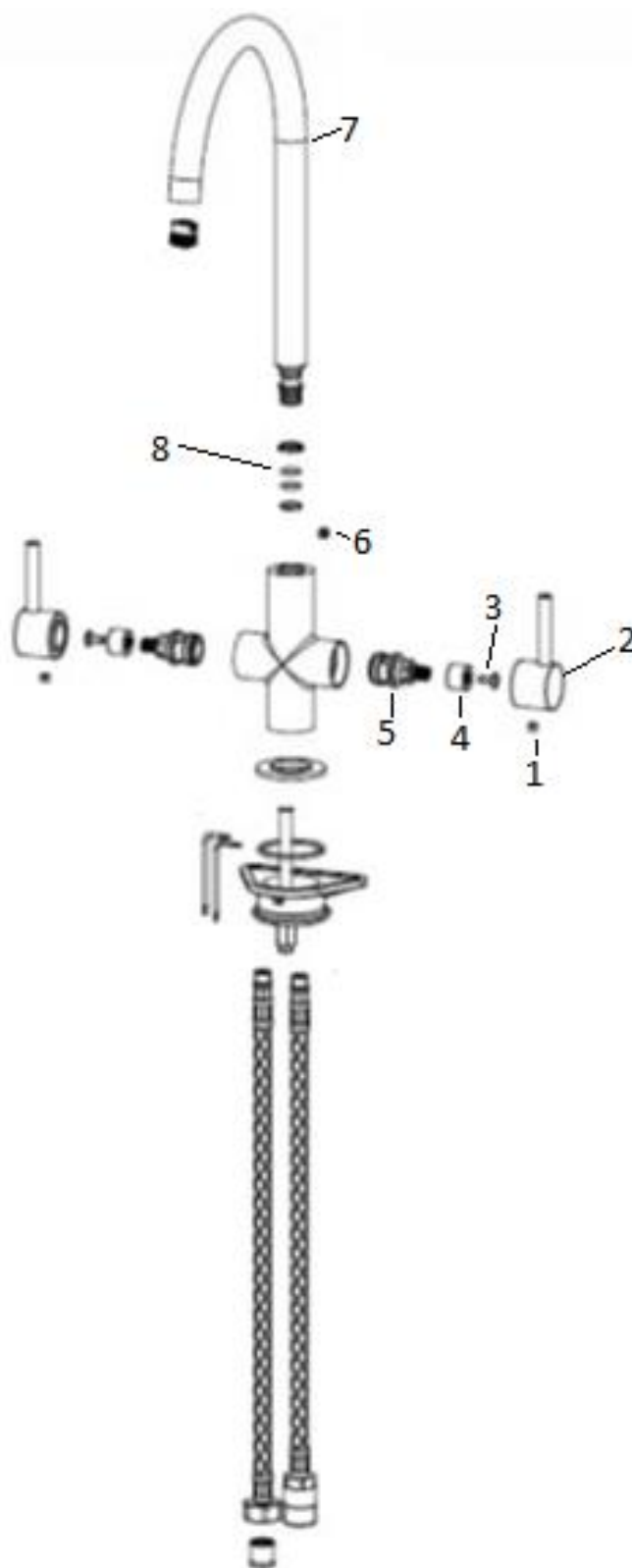

Central Services Ltd
Unit 17 Park Hall Business Village
Park Hall Road
Stoke-on-Trent
ST3 5XA

01782 599258
ks-ukcentralservices.gb@franke.com

*Make
it
Wonderful*

FRANKE